



5

COLLECTION

The stool specimens for this test must be collected on three separate days. It is preferable, but not necessary, to collect on consecutive days but the final collection must be made within seven days of the first.

DAY 1 COLLECTION		DAY 2 COLLECTION	
Use Contents from DAY 1 Bag		Use Contents from DAY 2 Bag	
Make sure that the patient's name, date of birth and the date of collection are written on the vial.			
Remove the cap from the BLACK top vial and add stool following the instructions on page 4.			
Place the BLACK top vial back into the DAY 1 zip-lock bag.	Place the BLACK top vial back into the DAY 2 zip-lock bag.		
Store bags in refrigerator prior to shipping. Do not freeze.			

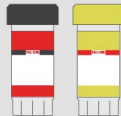
DAY 3 COLLECTION	
Use Contents from DAY 3 Bag	
Make sure that the patient's name, date of birth and the date of collection are written on all vials.	
Remove the caps from the YELLOW top vial and the BLACK top vial and add stool following the instructions on page 4. Place the YELLOW top vial and the BLACK top vial back into the DAY 3 zip-lock bag. Store bag in refrigerator prior to shipping. Do not freeze.	

6

SHIPPING

RETURNING YOUR SAMPLES

Please refer to the 'Returning your Specimen' instruction sheet, also enclosed within the kit box

The minimum sample requirement for ANY TEST is 1 x black vial & 1 x yellow vial.

If your test is a 1 Day Test, you must submit 1 x Black & 1 x Yellow;
If your test is a 2 Day Test, you must submit 2 x Black & 1 x Yellow;
If your test is a 3 Day Test, you must submit 3 x Black & 1 x Yellow.

Ideally, for a 3 day test, collect samples on Friday, Saturday and Sunday, and despatch on Monday. Always despatch the samples on the day, or day after the last sample is collected, and the last day of despatch must be a Wednesday.

PREPARE THE PACKAGE

1. Fill out the Test Requisition:

- ✓ Patient name, date of birth, gender, and date of collection is recorded

2. Place DAY 1, DAY 2 and DAY 3 collection bags into the kit box. Place any unused vials (in collection bags) in the box. Place the Test Requisition into the kit box and close.

Please ship as soon as possible. If you cannot ship the specimen on the day of collection, store the White top vial in the freezer and the other vials in the refrigerator until ready to ship.

CP+P

Culture, PCR + Parasitology

COLLECTION INSTRUCTIONS
STOOL SPECIMEN

SCIENCE + INSIGHT

Distributed by
regenerus labs



Read all instructions before collecting specimens.

2 KIT CONTENTS

If you are missing kit components, call Regenerus Laboratories on +442037500870 for assistance.



Kit Box



Requisition Form

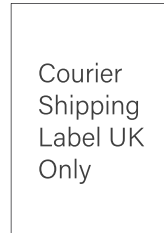

Courier Shipping Label UK Only

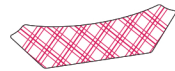

Stool Collection Containers (3)

DAY 1 BAG	DAY 2 BAG	DAY 3 BAG
*BLACK top vial 	*BLACK top vial 	*BLACK top vial *YELLOW top vial
Glove Absorbent material	Glove Absorbent material	Glove Absorbent material

*The BLACK and YELLOW top vials are filled to the middle of the vial with liquid preservative. If the liquid levels fall below the middle of the vial or there is evidence of leakage, call Customer Service for assistance. **Caution:** avoid contact of the skin and eyes with the fluid in vials. If you get fluid in your eyes, flush with water for 15 minutes. If your skin comes in contact with vial fluid, wash with soap and water. If ingested, please contact a physician.

3 IMPORTANT PREP INFO

BEFORE YOU START: Please read all of the instructions carefully before beginning. Consult your physician for specific instructions and before stopping any medications.

DISCONTINUE THE FOLLOWING	
2 weeks before test	Antibiotics, antiparasitics, antifungals, or probiotic supplements, proton pump inhibitors (PPIs) and Bismuth
2 days before test	Aspirin and other NSAIDs, digestive enzymes, laxatives (particularly mineral oil, castor oil, and glycerin enemas/suppositories), activated charcoal, betaine HCl, antacids or bentonite clay

OTHER INFORMATION		
Do not collect samples when there is active bleeding from hemorrhoids or menstruation	Wait at least 4 weeks from a colonoscopy or barium enema before collecting	Do not contaminate the stool with urine or water

WHICH BAG CONTENTS TO USE			
Patients will collect stool over 1, 2, or 3 days, depending on the order from the physician. Confirm this detail before stool collection.			
	DAY 1 BAG	DAY 2 BAG	DAY 3 BAG
Collect Stool on 3 Separate Days	1st collection	2nd collection	3rd collection
Collect Stool on 2 Separate Days	X	1st collection	2nd collection
Collect Stool on 1 day	X	X	only collection

4 COLLECTION

HOW TO COLLECT YOUR STOOL SAMPLE

Write the patient's name, date of birth and the date collected on each specimen vial. **The test cannot be performed without the patient information on the vials.**

1. Put on glove and collect stool into the paper collection container supplied. If possible, void urine prior to collecting stool to avoid mixing it with the stool sample.

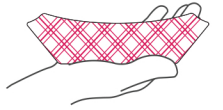

2. Remove the cap from the vial and using the attached spoon transfer stool specimen into the vial. Take multiple portions from different areas of the collection container.

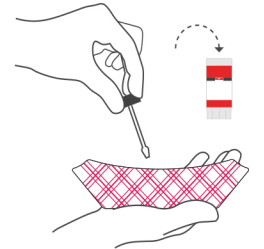

3. Add enough stool until it reaches the **fill line**. **DO NOT OVERFILL**. Screw the cap on tightly.

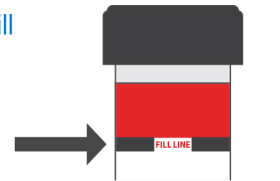

4. Shake the vial vigorously for approximately 30 seconds to mix stool with preservative.

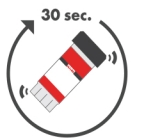

Make sure to use the correct vials for each day of collection. See Page 5 for more details.